

Abisagrada RT70 HO / C16

SISTEMA **ABATIBLE**



SISTEMAS integra

www.grupolaminex.com

| | |
|-------------------------------|---|
| Secciones | Marco 70 mm Hoja 71.7 mm |
| Longitud de poliamida (Marco) | 26 mm. Poliamida 6.6 con 25% de fibra de vidrio |
| Longitud de PVC (Hoja) | 30 mm. |
| Acrilamiento | De 26 a 58.5 mm |
| Transmitancia térmica | Uw desde 0,9 W/m ² K Valores calculados según norma UNE-EN ISO 10077-1:2010 sobre diferentes tipologías, dimensiones y vidrios. Zonas de cumplimiento del CTE: α A B C D E en función de la transmitancia del vidrio |
| Aislamiento acústico | 45 dB (Según anexo B de la norma UNE-EN 14351:2006 +A1:2001) |
| Dimensiones máximas | Ancho (L) = 1700 mm y alto (H) = 2500 mm (consultar dimensiones máximas según tipología) |
| Peso máximo por hoja | 170 kg. (consultar dimensiones máximas según tipología) |
| Clasificaciones | |
| Permeabilidad al aire | CLASE 1 CLASE 2 CLASE 3 CLASE 4 |
| Estanqueidad al agua | 1A 2A 3A 4A 5A 6A 7A 8A 9A E1200 |
| Resistencia al viento | CLASE C1 CLASE C2 CLASE C3 CLASE C4 CLASE C5 |

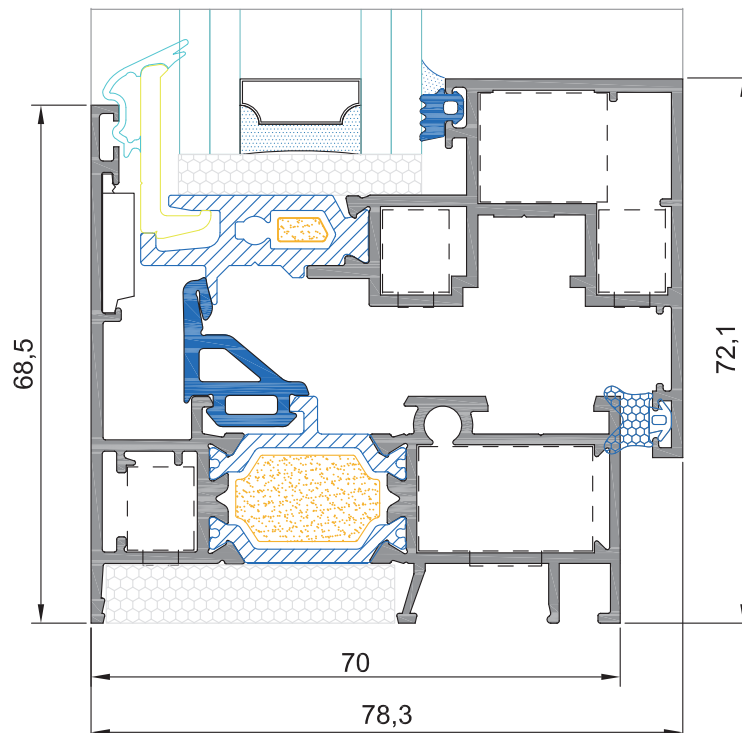

LEXRT70120

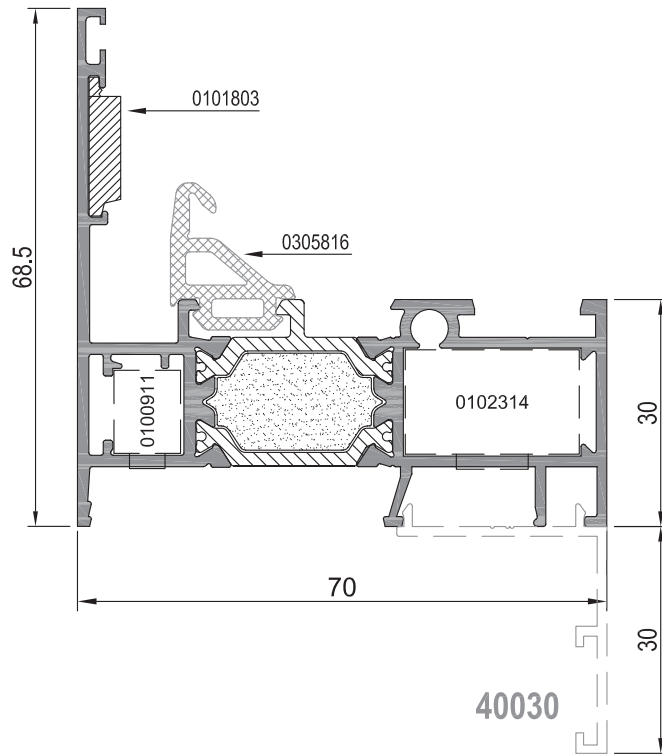

LEXRT70150

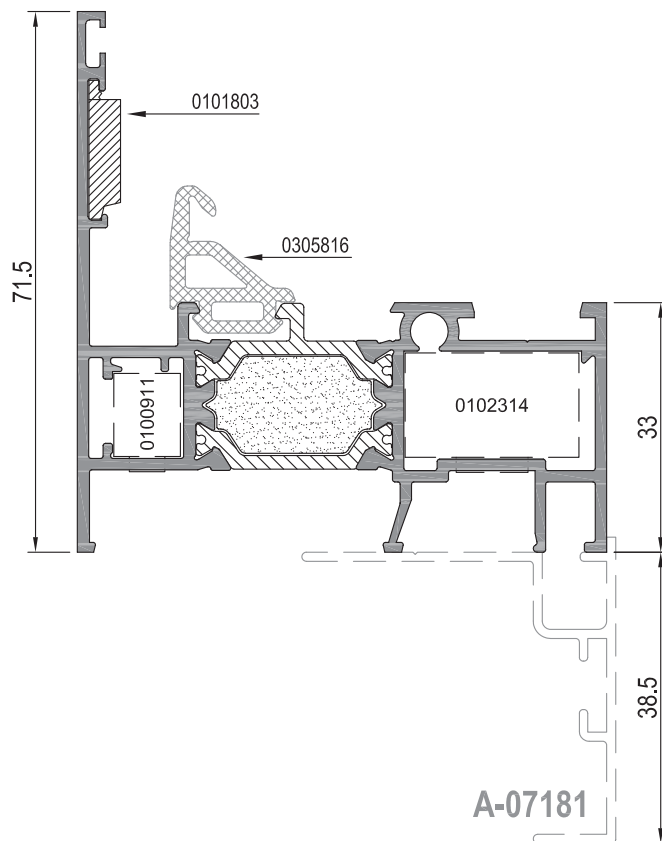

LEXRT70163

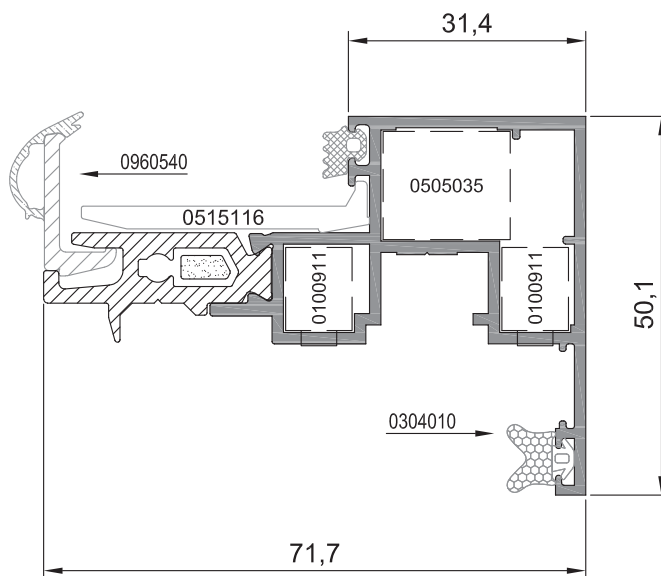

LEXRT70165

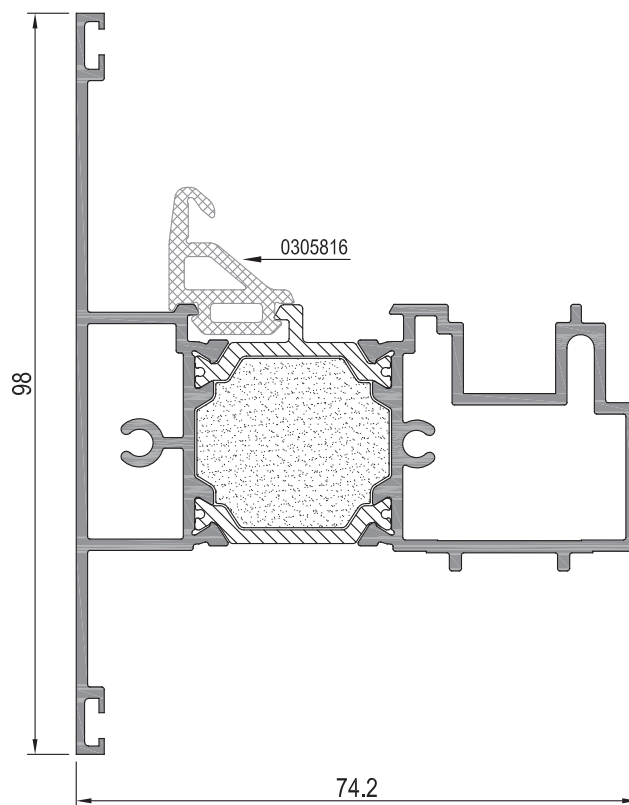

LEXRT70490

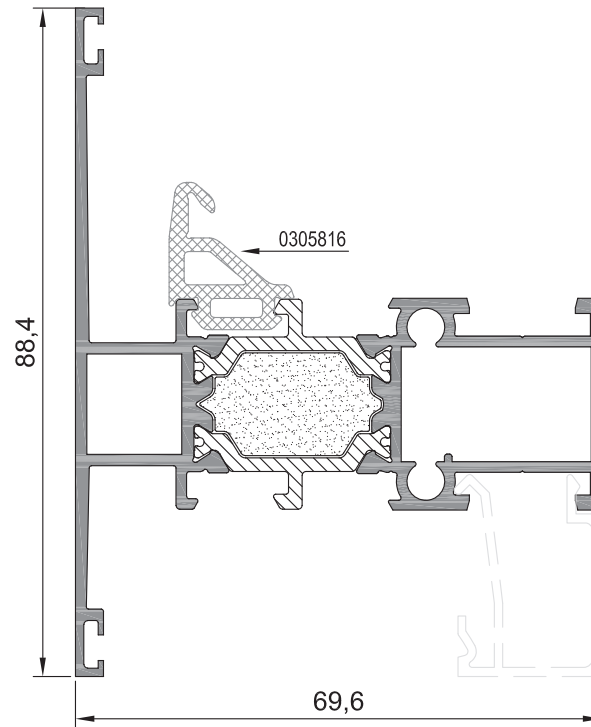

LEX70001

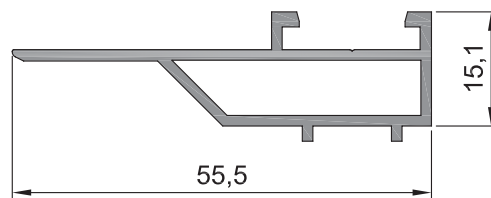

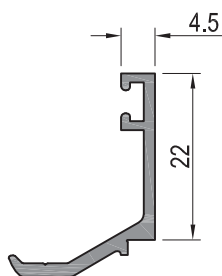

Junquillo 4,5 mm
LEX40082

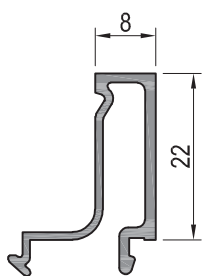

Junquillo 8 mm
LEX40508

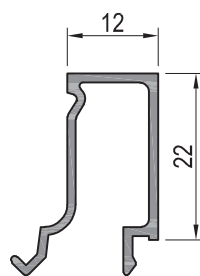

Junquillo 12 mm
LEX40512

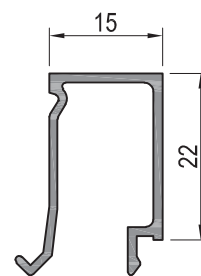

Junquillo 15 mm
LEX40515

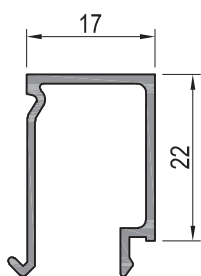

Junquillo 17 mm
LEX40517

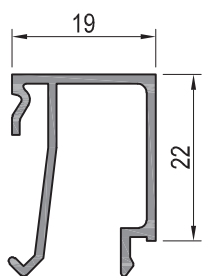

Junquillo 19 mm
LEX40519

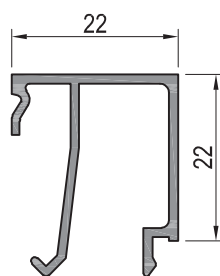

Junquillo 22 mm
LEX40522

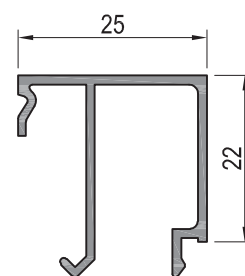

Junquillo 25 mm
LEX40525

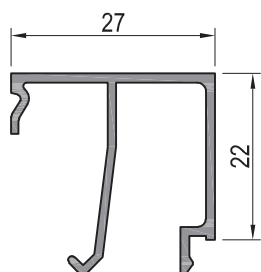

Junquillo 27 mm
LEX40527

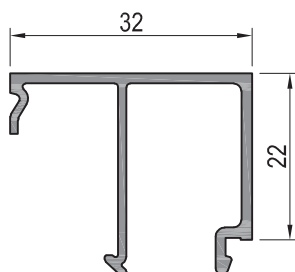

Junquillo 32 mm
LEX40532

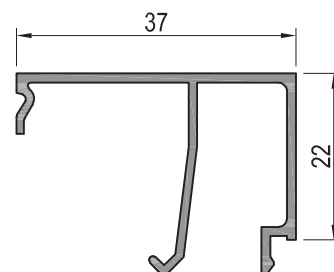

Junquillo 37 mm
LEX40537

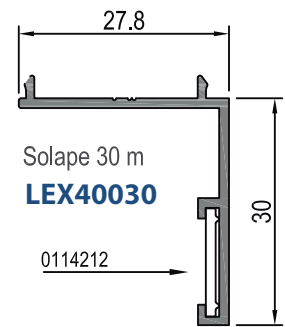
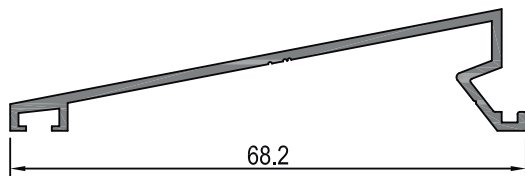
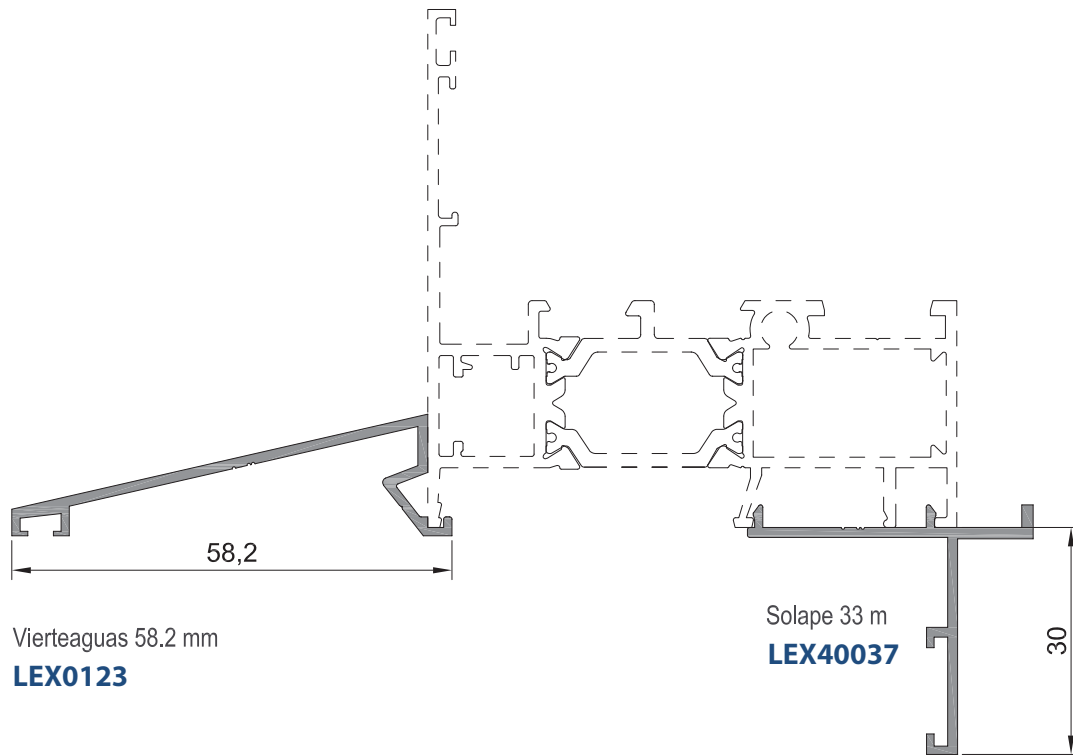

Vieriteaguas 68.2 mm
LEX0122

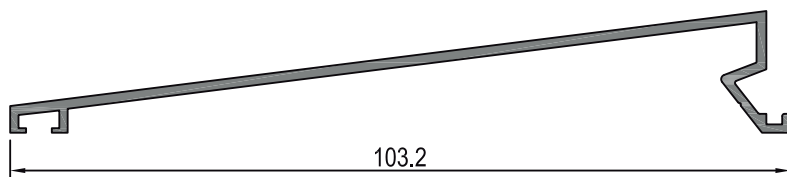

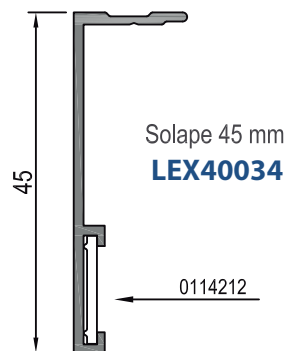
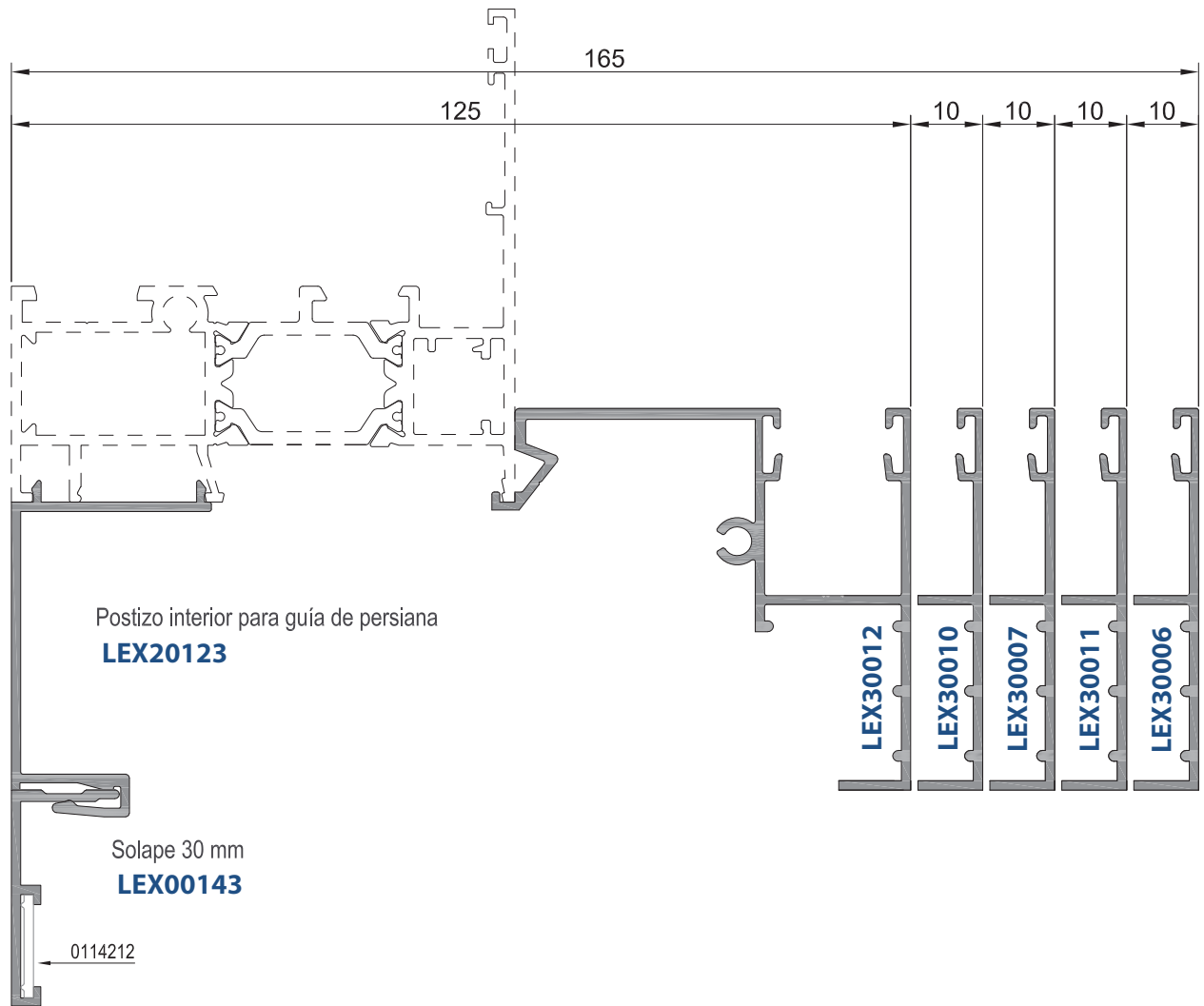

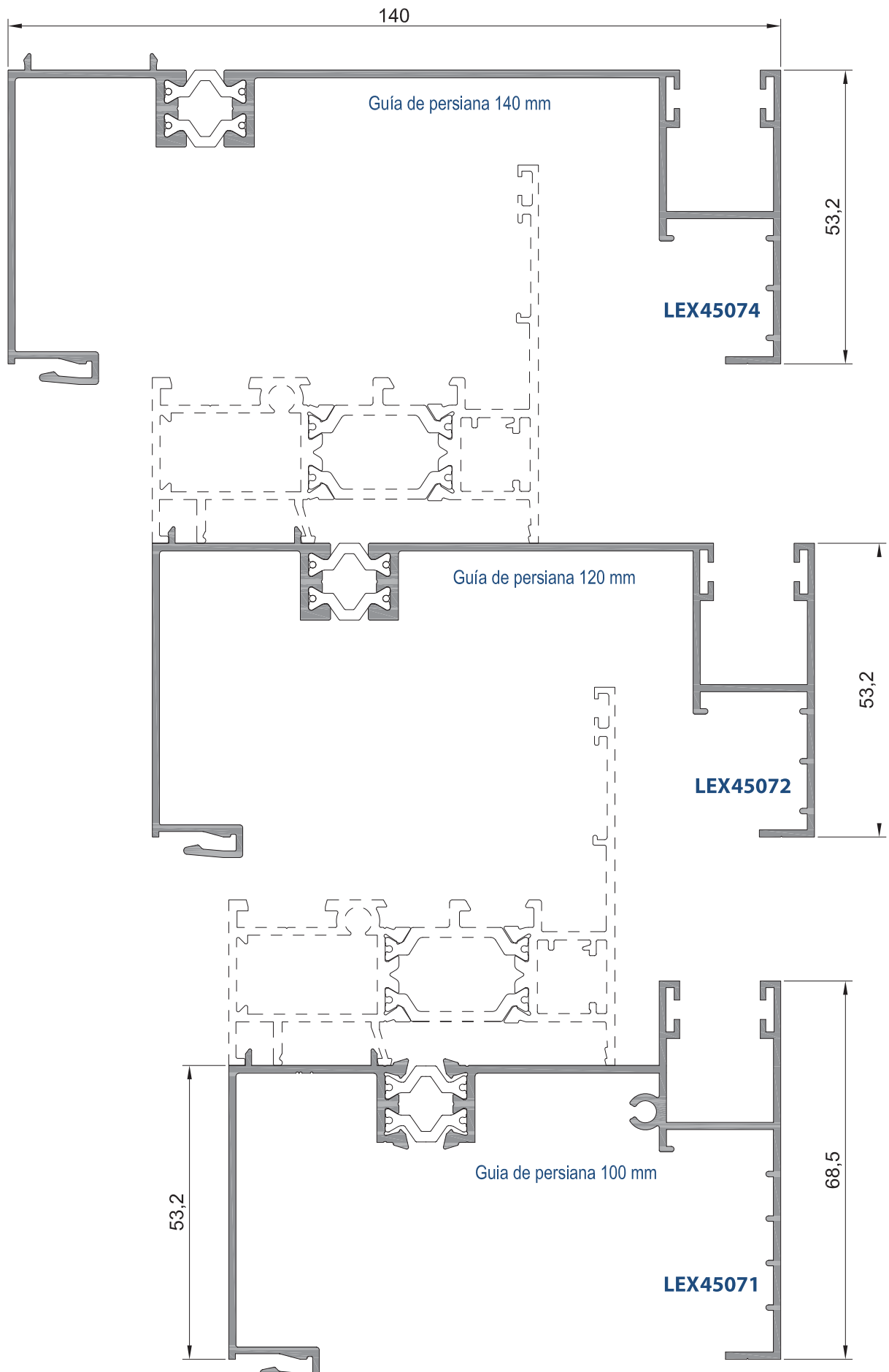

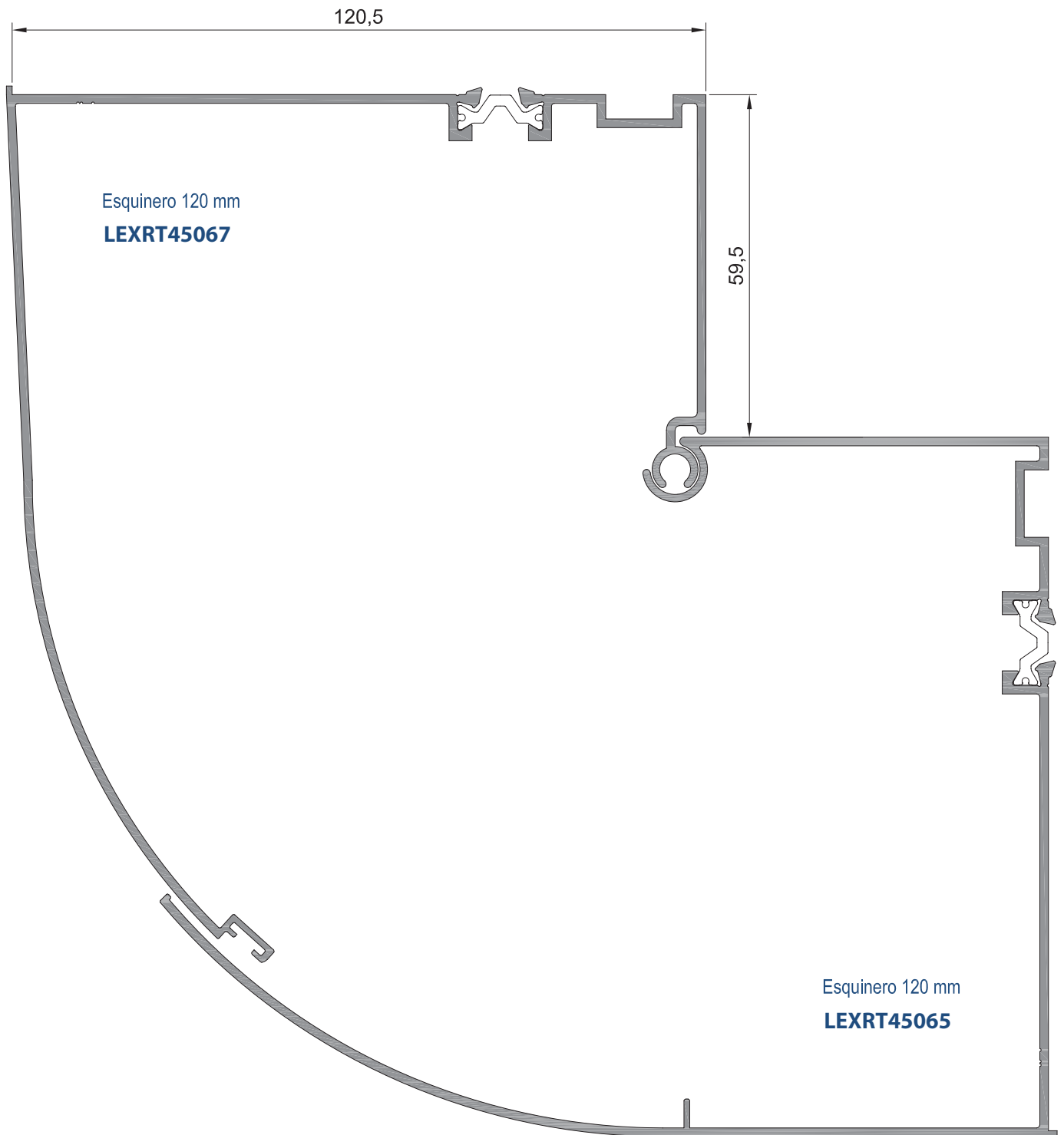

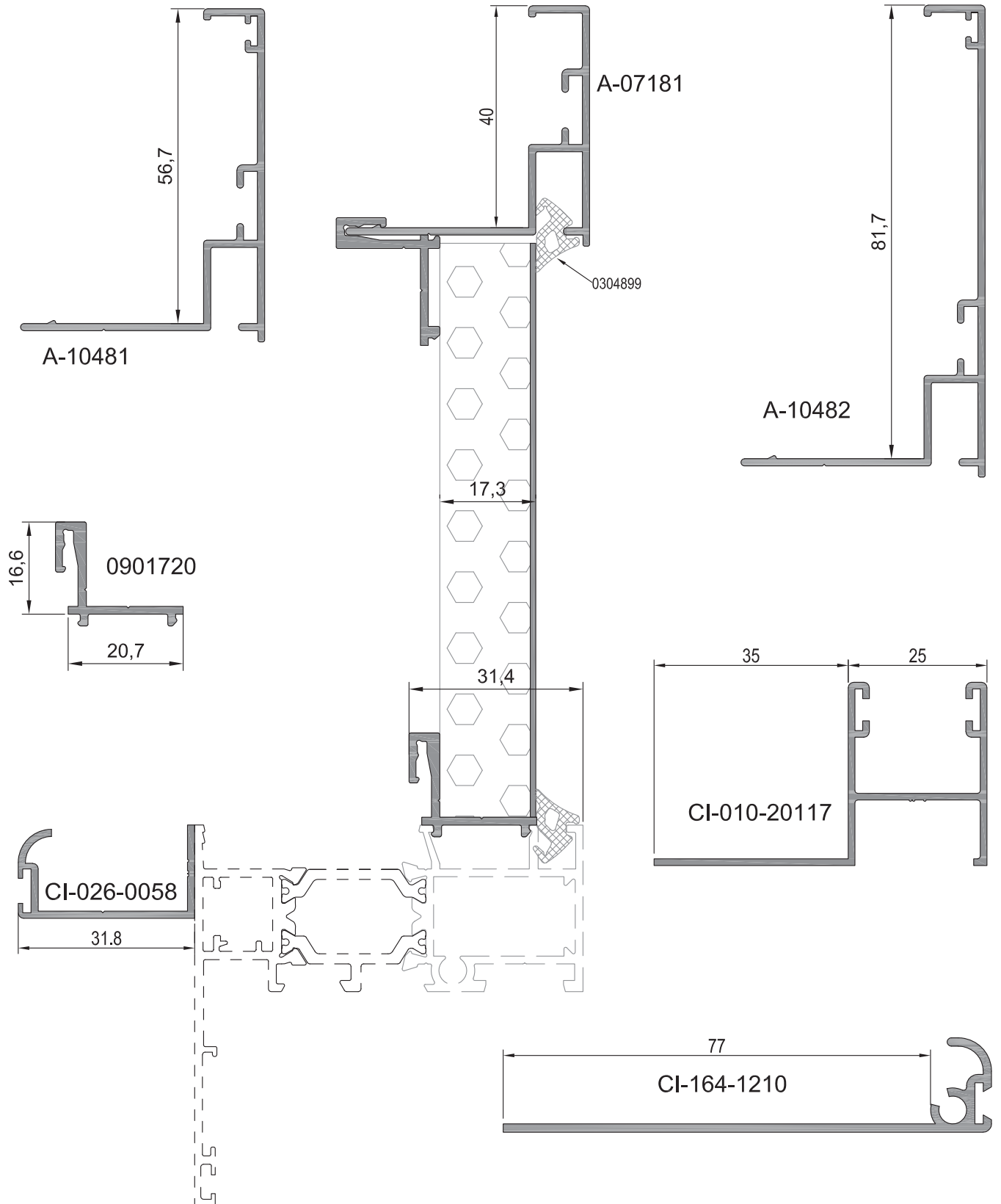

H0100911

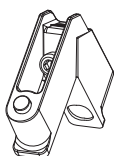

Escuadra 9 x 11

H0102314

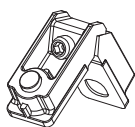

Escuadra 23 x 14

H0505035



Escuadra tubular hoja

H0101803

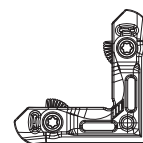

Escuadra alineamiento exterior marco

H0114212

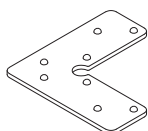

Escuadra alineamiento inox. 14 x 1

H0101111

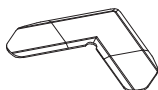

Escuadra alineamiento inox. 11 x 1

H0118412

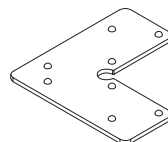

Escuadra alineamiento inox. 18 x 1

H0113412

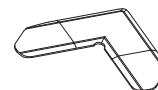

Escuadra alineamiento inox. 13 x 1

H0103318



Escuadra alineación forro

H0201815

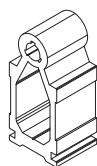

Unión travesaño V

H0201837

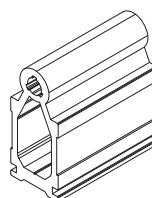

Unión travesaño B

H0501667

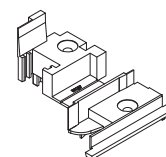

Tapa inversor RT70HOC16

H0509025

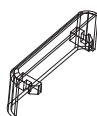





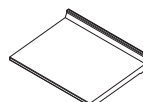



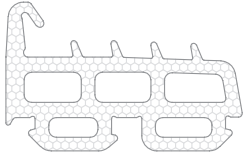
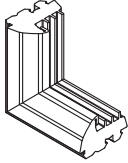
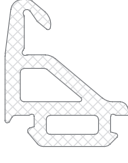
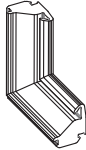



Tapa salida de agua

H0515116

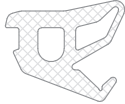

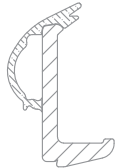
Calzo vidrio

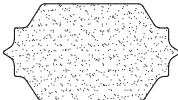
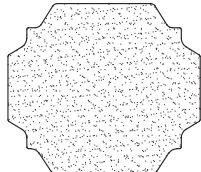
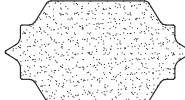
| | | | |
|--|---|---|--|
| <p>H0304016</p>  <p>Junta central, RT70</p> | <p>H0304716</p>  <p>Esquina para junta central</p> | <p>H0305816</p>  <p>Junta central EPDM, RT70</p> | <p>H0306816</p>  <p>Esquina para junta 0305816</p> |
| <p>H0304010</p>  <p>Junta interior hoja celular</p> | <p>H0304005</p>  <p>Junta acristalamiento interior</p> | <p>H0304001</p>  <p>Junta acrist. exterior</p> | |
| <p>H0304896</p>  <p>Junta acrist. interior 3 mm.</p> | <p>H0304897</p>  <p>Junta acrist. interior 4 mm.</p> | <p>H0304898</p>  <p>Junta acrist. interior 5 mm.</p> | <p>H0304899</p>  <p>Junta acrist. interior 6/7 mm.</p> |
| <p>H0304890</p>  <p>Junta acrist. interior 8/9 mm.</p> | <p>H0304891</p>  <p>Junta acrist. interior 10 mm.</p> | <p>H0351672</p>  <p>Junta aislante epdm 0x1 (Rollos)</p> | <p>H0960540</p>  <p>Junquillo acristalamiento</p> |
| AISLANTES | | | |
| <p>H1370V163</p>  <p>Aislante interior 70163</p> | <p>HXXX</p>  <p>Aislante interior 70120</p> | <p>HXXX</p>  <p>Aislante interior 70165</p> | <p>HXXX</p>  <p>Aislante interior 70490</p> |

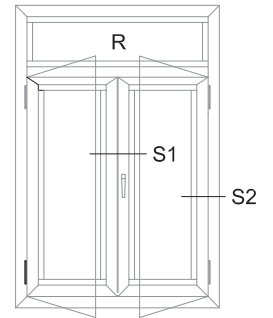
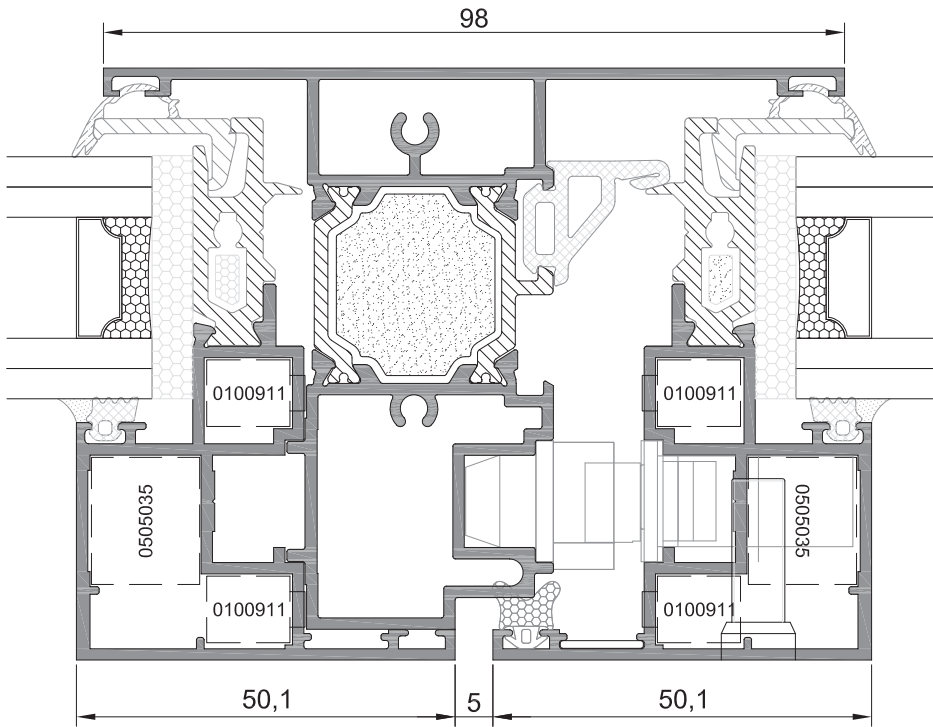

— S1

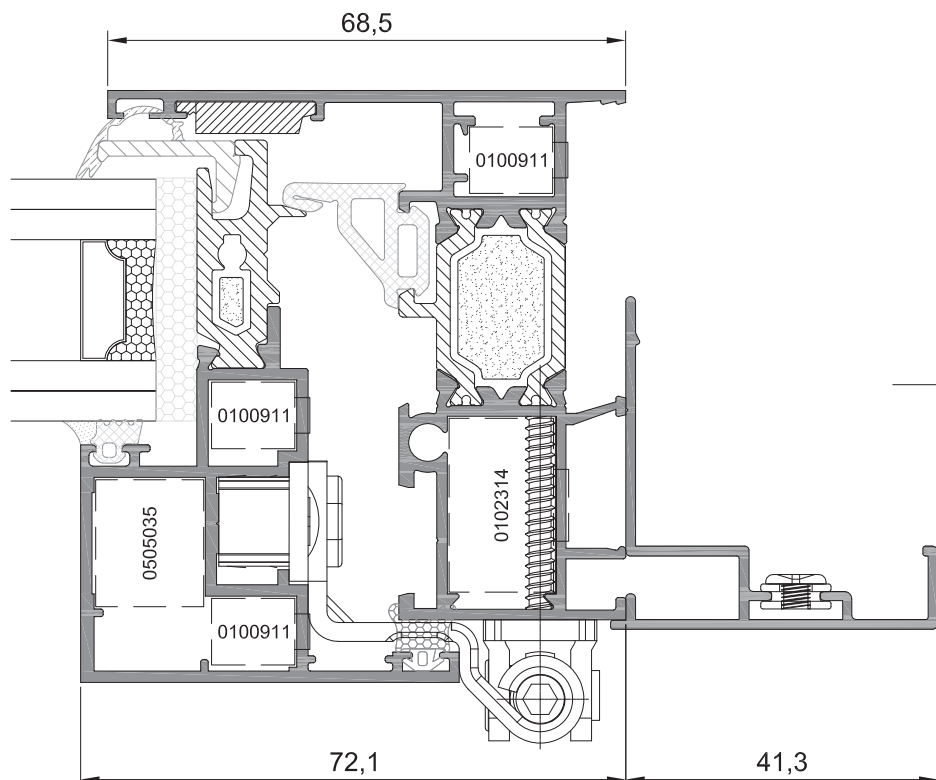



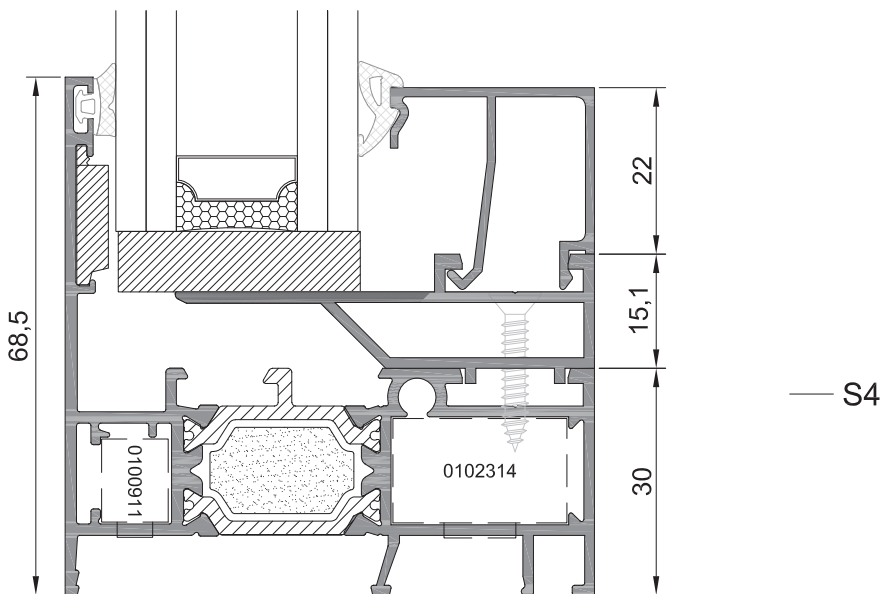
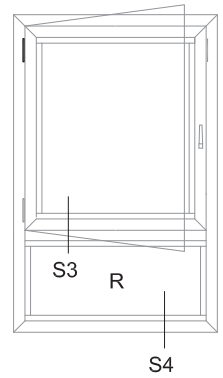
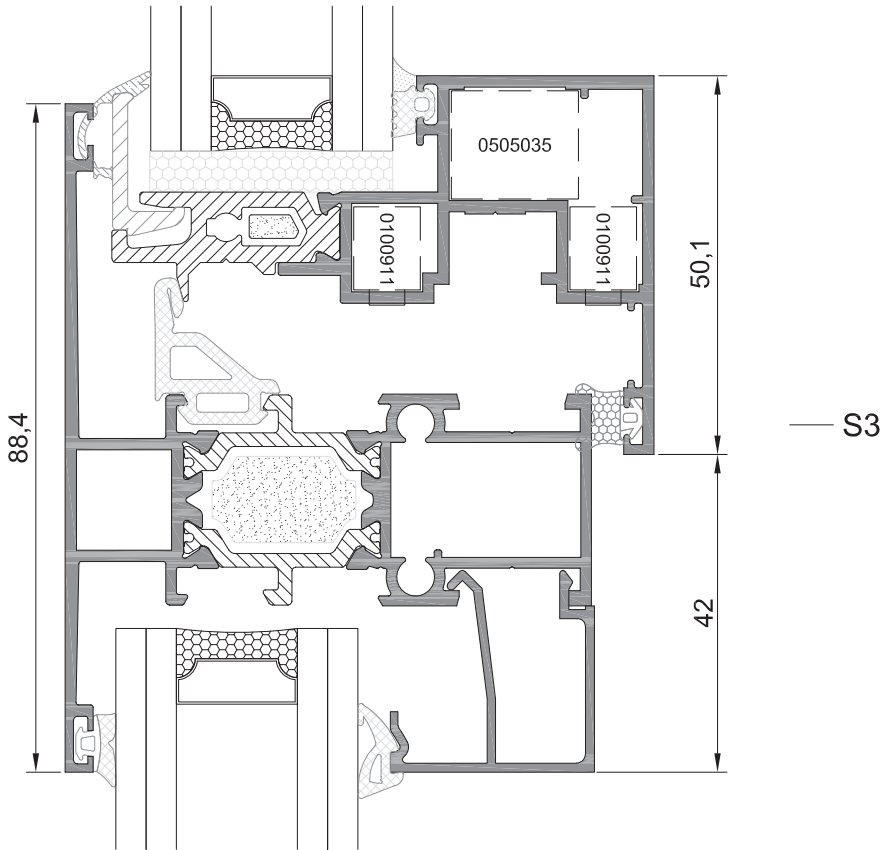

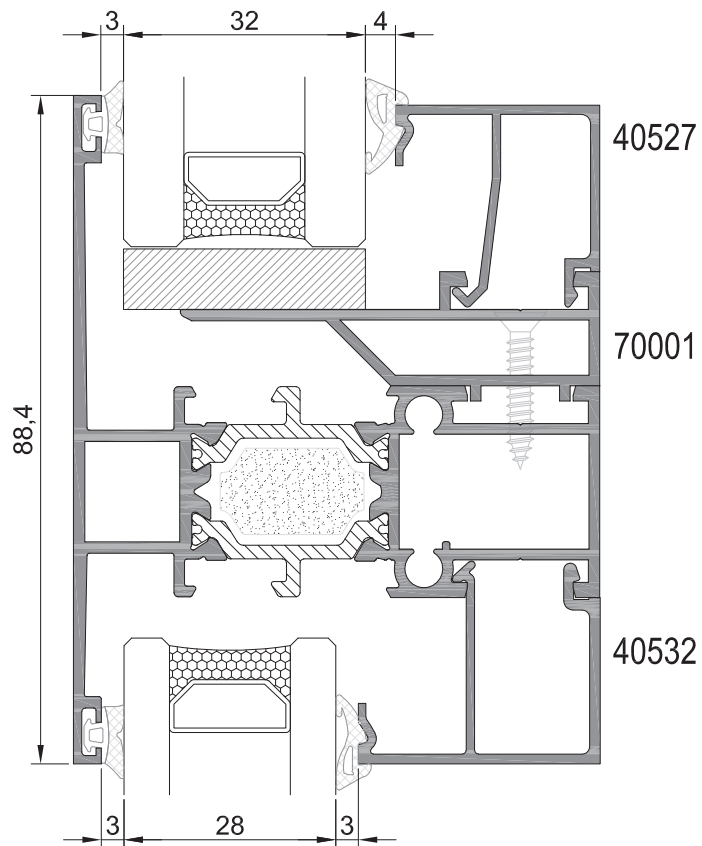
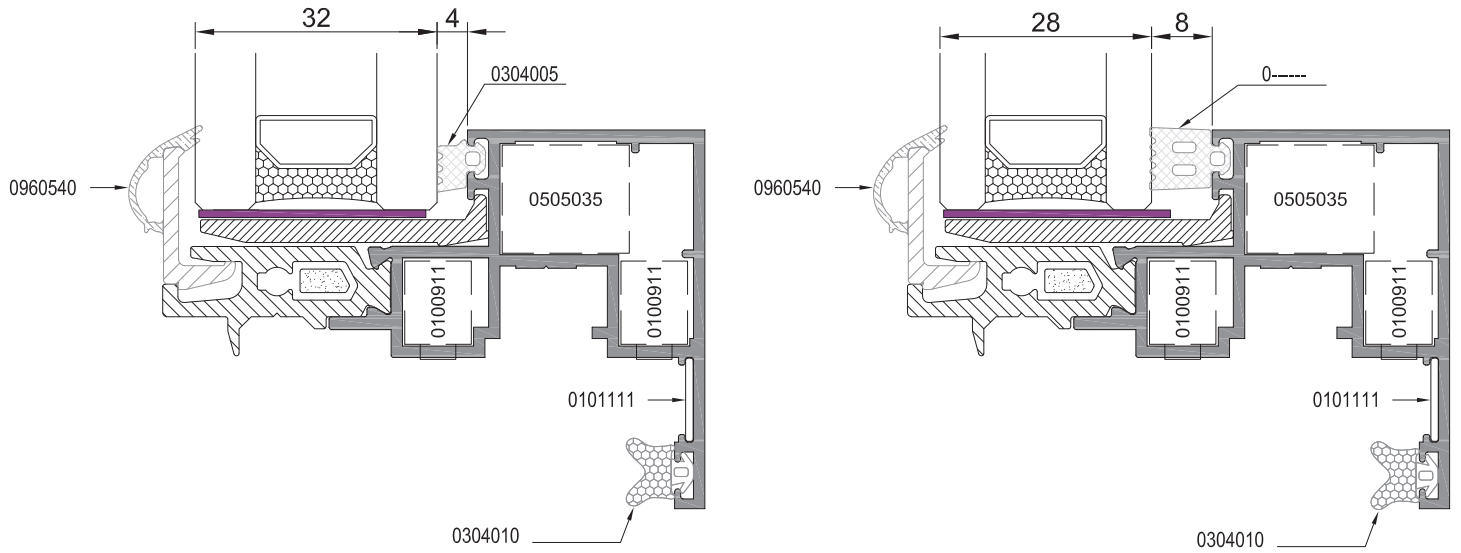

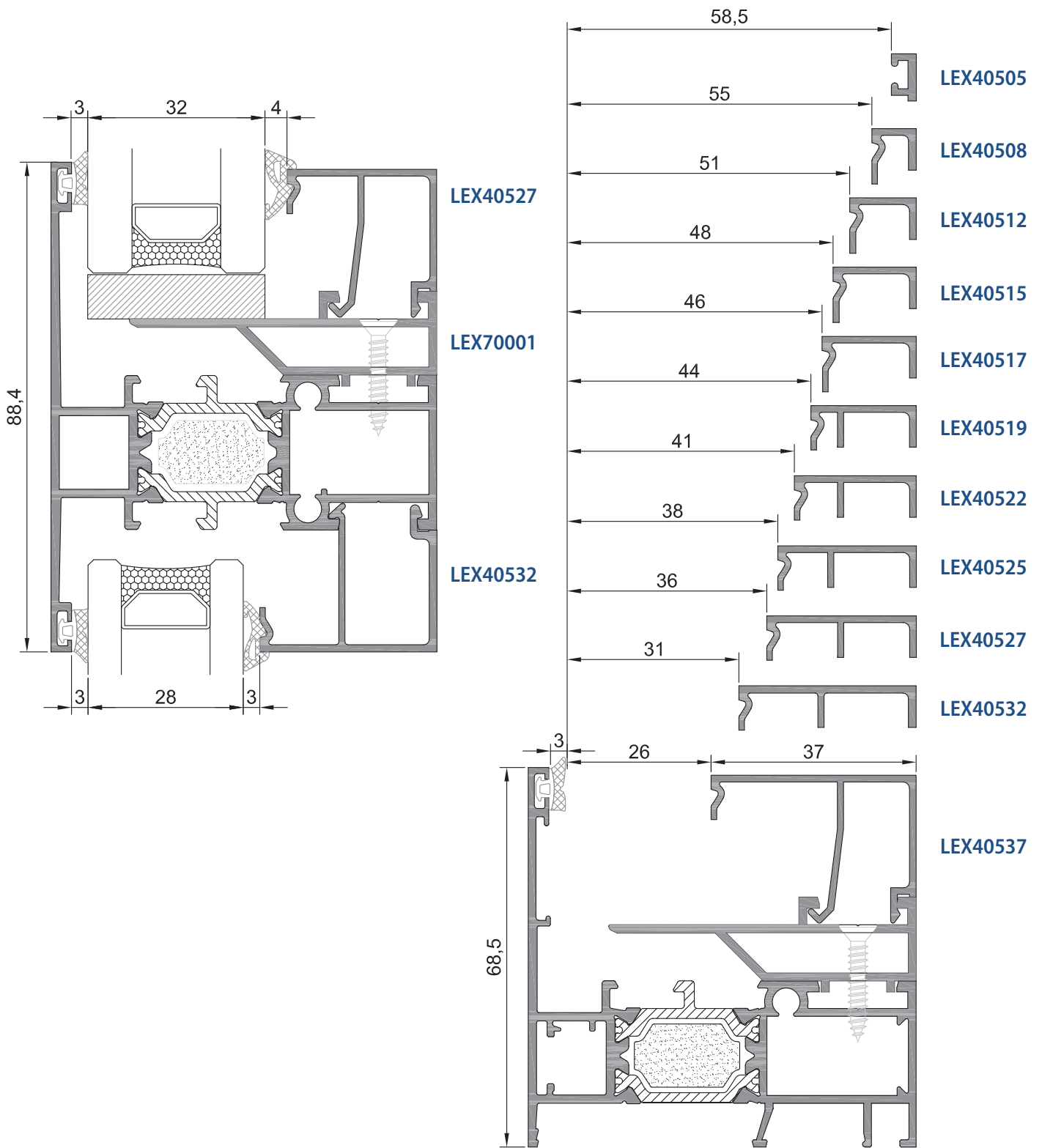
— S2







| | | | | | | |
|---|---|---|---|---|---|---|
|  |  |  |  |  |  |  |
| | H304896 | H304897 | H304898 | H304899 | H304890 | H304891 |
| 3 mm | 2,5 a 3,5 mm | 3,5 a 4,5 mm | 4,5 a 5,5 mm | 6 a 8 mm | 8 a 9 mm | 10 mm |

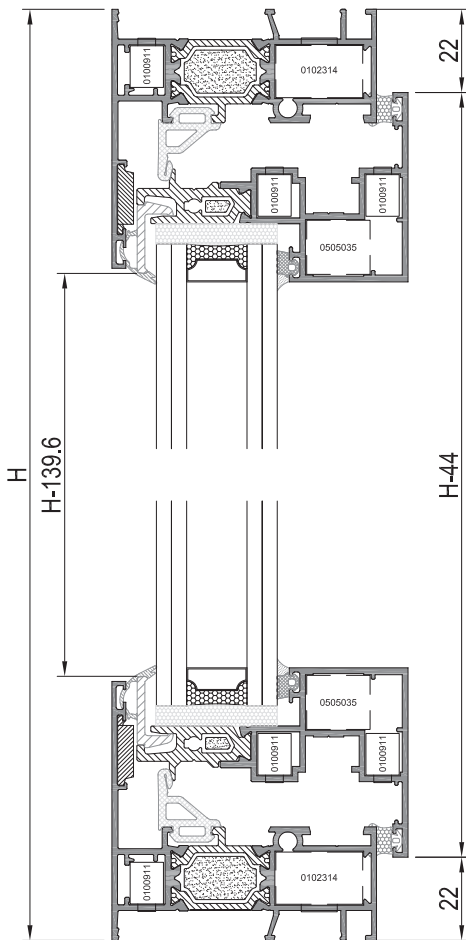

| Den. | Und. | Referenc. | Descripción | Corte | Medidas |
|-----------------|------|-----------|-------------------------------|-------|-----------|
| Hoja Marco | 2 | 70120 | Marco lateral | | H |
| | 2 | 70120 | Marco superior / inferior | | L |
| Hoja | 2 | 70163 | Hoja lateral | | H - 44 |
| | 2 | 70163 | Hoja superior / inferior | | L - 44 |
| | 2 | 0960540 | Junquillo lateral | | H - 139,6 |
| | 2 | 0960540 | Junquillo superior / inferior | | L - 102 |
| Acristalamiento | | | L-123,4 x H-123,4 | | |

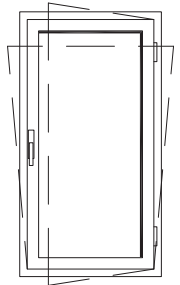

| Den. | Unidades | Referenc. | Descripción |
|------------|----------|-----------|-------------------------------|
| Accesorios | 4 | 0102314 | Escuadra 23 x 14 |
| | 12 | 0100911 | Escuadra 9 x 11 |
| | 4 | 0505035 | Escuadra tubular hoja |
| | 4 | 0101803 | Escuadra alin. exterior marco |
| | 4 | 0101111 | Escuadra alineamiento 11 x 1 |
| | 2 | 0509025 | Tapa salida de agua |
| Juntas | 2L + 2H | 0304016 | Junta central |
| | 4 | 0304716 | Esquina junta central |
| | 2L + 2H | 0304010 | Junta interior hoja celular |
| | 2L + 2H | 0304005 | Junta acrist. interior |

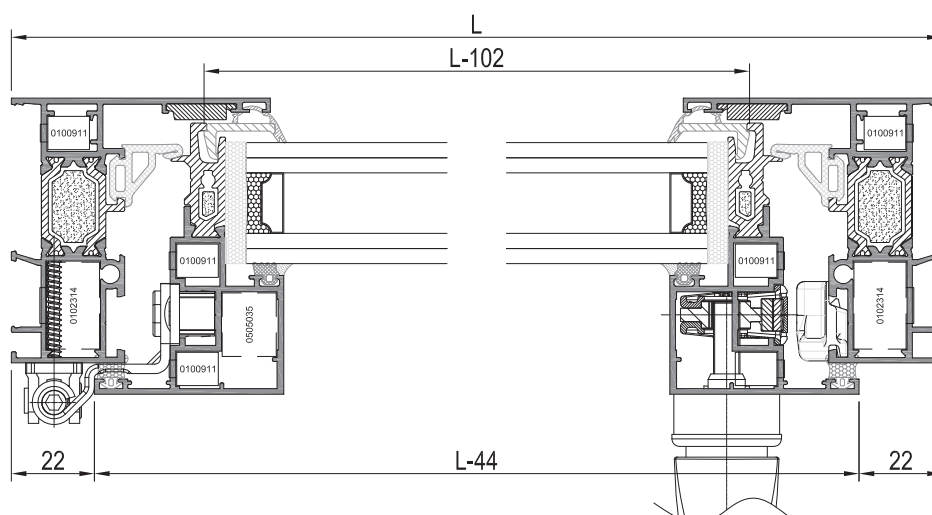

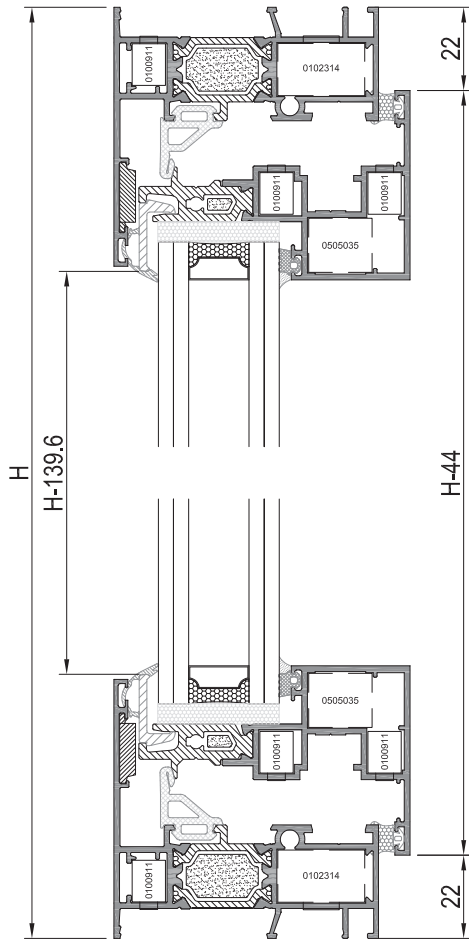

| Den. | Und. | Referenc. | Descripción | Corte | Medidas |
|-----------------|------|-----------|-------------------------------|-------|------------|
| Hoja Marco | 2 | 70120 | Marco lateral | | H |
| | 2 | 70120 | Marco superior / inferior | | L |
| Hoja | 4 | 70163 | Hoja lateral | | H - 44 |
| | 4 | 70163 | Hoja superior / inferior | | L/2 - 24.5 |
| | 1 | 70165 | Inversor | | H - 144 |
| | 4 | 0960540 | Junquillo lateral | | H - 139.6 |
| | 4 | 0960540 | Junquillo superior / inferior | | L/2 - 82.5 |
| Acristalamiento | | | L/2-104 x H-123,4 | | |

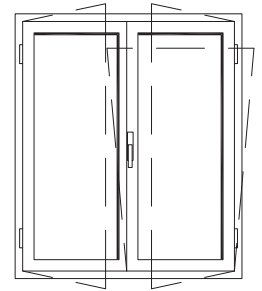

| Den. | Unidades | Referenc. | Descripción |
|------------|----------|-----------|-------------------------------|
| Accesorios | 4 | 0102314 | Escuadra 23 x 14 |
| | 20 | 0100911 | Escuadra 9 x 11 |
| | 8 | 0505035 | Escuadra tubular hoja |
| | 4 | 0101803 | Escuadra alin. exterior marco |
| | 8 | 0101111 | Escuadra alineamiento 11 x 1 |
| | 2 | 0509025 | Tapa salida de agua |
| | 1 | 0501667 | Conjunto tapa inversor |
| Juntas | 2L + 3H | 0304016 | Junta central |
| | 4 | 0304716 | Esquina junta central |
| | 4L + 4H | 0304010 | Junta interior hoja celular |
| | 4L + 4H | 0304005 | Junta acrist. interior |

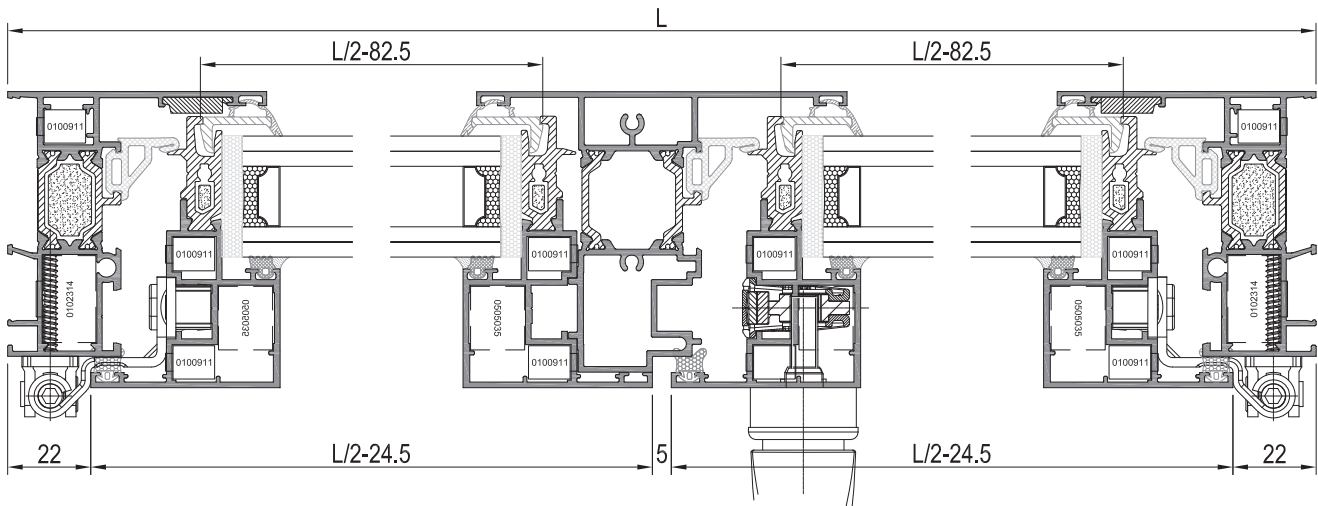

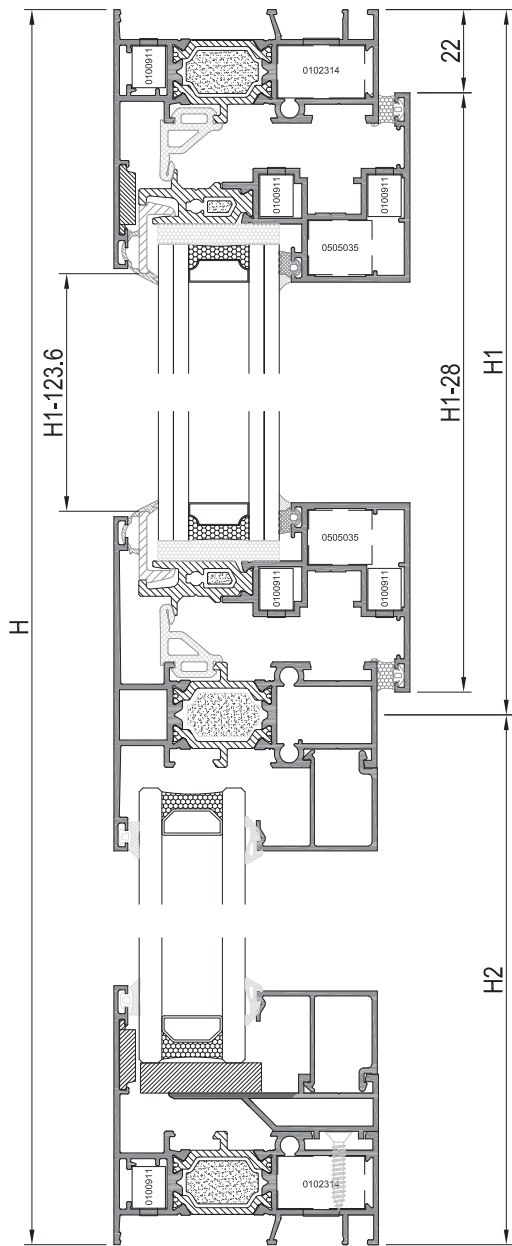

| Den. | Und. | Referenc. | Descripción | Corte | Medidas |
|----------------|------|-----------|----------------------------|-------|------------|
| Marco | 2 | 70120 | Marco lateral | | H |
| | 2 | 70120 | Marco superior / inferior | | L |
| Hoja | 2 | 70163 | Hoja lateral | | H1 - 28 |
| | 2 | 70163 | Hoja superior / inferior | | L - 44 |
| T | 1 | 70490 | Travesaño (fresado) | | L - 50 |
| | 2 | 70001 | Complemento fijo lateral | | H2 - 44 |
| | 1 | 70001 | Complemento fijo inferior | | L - 60 |
| | 2 | 0960540 | Junquillo lateral (Hoja) | | H1 - 123.6 |
| | 2 | 0960540 | Junquillo sup./inf. (Hoja) | | L - 102 |
| | 2 | 40532 | Junquillo lateral (Fijo) | | H2 - 103.1 |
| | 2 | 40532 | Junquillo sup./inf. (Fijo) | | L - 90.2 |
| Acrist. (Hoja) | | | L-123.4 x H1-107.4 | | |
| Acrist. (Fijo) | | | L-98 x H2-67 | | |

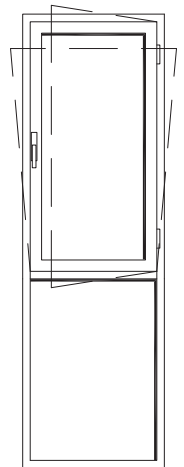

| Den. | Undidades | Referenc. | Descripción |
|------------|-----------|-----------|-------------------------------|
| Accesorios | 4 | 0102314 | Escuadra 23 x 14 |
| | 12 | 0100911 | Escuadra 9 x 11 |
| | 4 | 0505035 | Escuadra tubular hoja |
| | 4 | 0101803 | Escuadra alin. exterior marco |
| | 4 | 0101111 | Escuadra alineamiento 11 x 1 |
| | 2 | 0509025 | Tapa salida de agua |
| | 2 | 0101815 | Unión travesaño 18 x 15 |
| Juntas | 2L + 2H1 | 0304016 | Junta central |
| | 4 | 0304716 | Esquina junta central |
| | 2L + 4H1 | 0304010 | Junta interior hoja celular |
| | 4L + 2H | 0304001 | Junta acrist. exterior (Fijo) |
| | 4L + 2H | 0304005 | Junta acrist. interior |

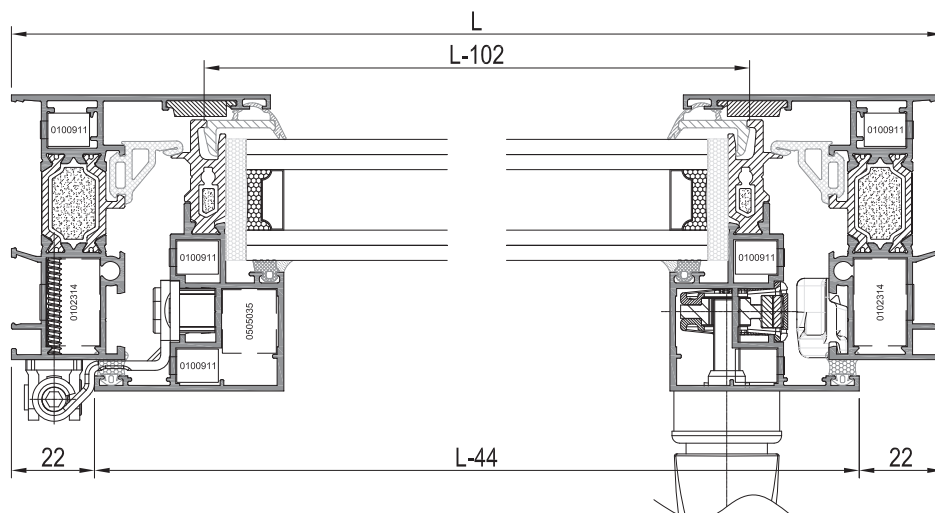

Tapón inversor referencia H0571670

Sistema RT70HO-C16

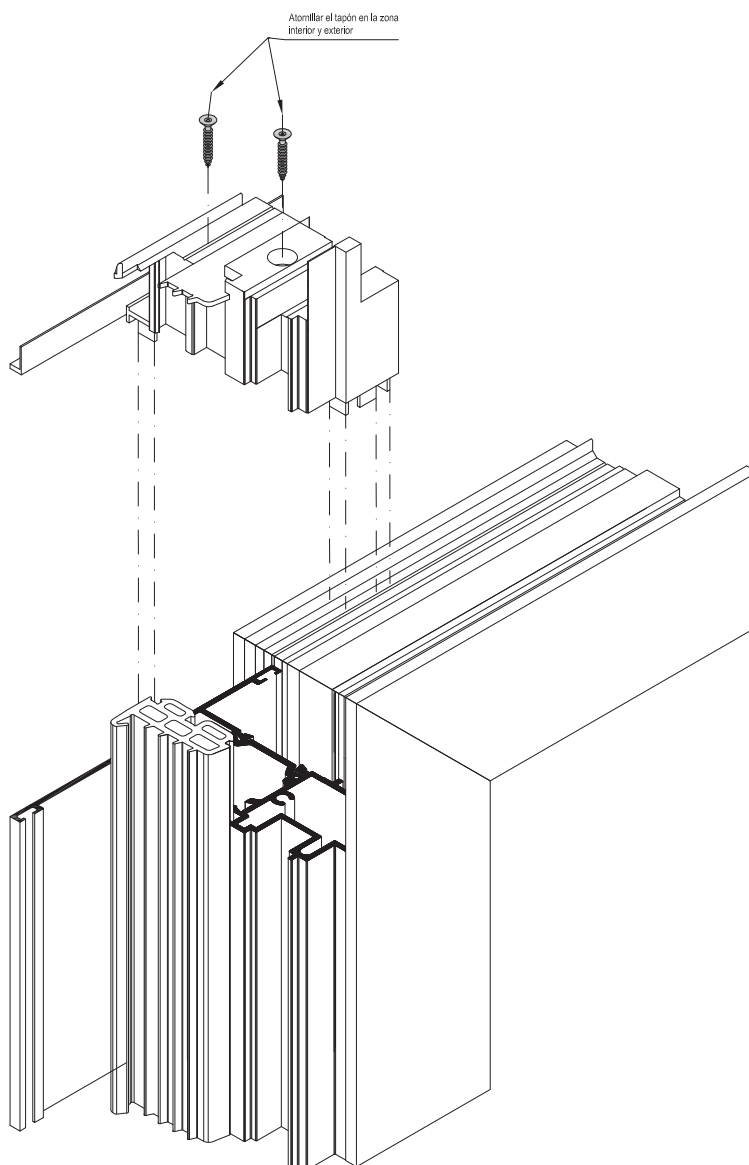

Colocación del tapón ref. 0501670 sobre el perfil inversor (ejemplo RT70HOC16)

DELEGACIONES

ANDALUCÍA

• ALMERÍA

Polígono San Rafael. C/ San Rafael, 12
04230 Huércal de Almería (Almería)
T. 950 140 611
almeria@grupolaminex.com

• CÁDIZ

Pol. Ind. Las Salinas de S. José. C/ Manantial, 14
11500 El Puerto de Santa María (Cádiz)
T. 956 860 842
cadiz@grupolaminex.com

• CAMPO DE GIBRALTAR

Pol. Ind. La Menacha
Ed. Ind. Almanzor, Naves 3 y 4
11205 Algeciras
T. 956 589 572
algeciras@grupolaminex.com

• CÓRDOBA

T. 957 280 101
cordoba@grupolaminex.com

• GRANADA

Pol. Ind. La Paz. Cmno. de la Torrecilla s/n
18200 Maracena (Granada)
T. 958 411 143
granada@grupolaminex.com

• JAÉN

Polígono Llanos del Valle
Ctra. de Granada, km. 337 - 23009 Jaén
T. 953 239 288
jaen@grupolaminex.com

• MÁLAGA

Pol. Ind. Santa Teresa
C/ Caleta de Vélez, 23 y 25
29006 Málaga
T. 952 243 432
malaga@grupolaminex.com

• SEVILLA

Ctra. Sevilla-Málaga, Km 8
41500 Alcalá de Guadaíra (Sevilla)
T. 955 631 966
sevilla@grupolaminex.com

ISLAS BALEARES

• MALLORCA

Pol. Ind. Son Rossinyol
C/ Gremi Cirurgians i Barbers, 21
07009 Palma de Mallorca (I. Baleares)
T. 971 430 259
baleares@grupolaminex.com

• MENORCA

T. 971 430 259
menorca@grupolaminex.com

CENTRAL

Pol. Ind. La Paz.
Cmno. de la Torrecilla, s/n
18200 Maracena (Granada)
T. 958 420 570
info@grupolaminex.com

DPTO. TÉCNICO

dtecnico@grupolaminex.com